

HydrauCalc

2023b Release



www.hydraucalc.com

APPLICATION DESCRIPTION

APPLICATION DESCRIPTION

HydrauCalc is a software application that allows accurate modeling and calculating of stabilized flows in piping elements as straight pipes, bends, changes of cross-section, tees, valves, orifices and more.

HydrauCalc is particularly suitable for pre-projects because it allows to estimate quickly the pressure losses of the components of a hydraulic installation, and thus to specify the characteristics of the pumps.

Friction Loss is calculated using the Darcy-Weisbach method, which provides accurate results for non-compressible fluids (liquids). This method also provides satisfactory results of reasonable accuracy for compressible fluids (gases) when the flow velocity is not very high.

HydrauCalc is mainly based on well-known and respected references in the field of fluid flow and pressure drop calculation.

THE REFERENCES

MAINLY REFERENCES

[1] Handbook of Hydraulic Resistance, I.E. Idelchik

[2] Internal Flow System, D.S. Miller

[3] CRANE - Flow of Fluids Through Valves, Fitting and Pipe - Technical Paper No. 410

[4] Pipe Flow - A Practical and Comprehensive Guide, D. C. Rennels, H. M. Hudson

THE GRAPHICAL USER INTERFACE

GRAPHICAL USER INTERFACE

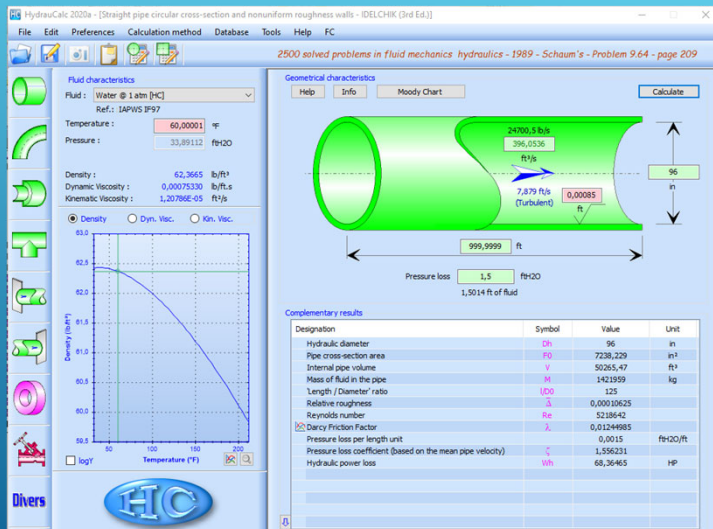

HydraulCalc - © François Corre 2017-2023

The graphical user interface is available in English, French or Spanish.

From this interface, the user selects the type of component he wants to calculate and the fluid carried in this component. It also provides the necessary input data (fluid and flow characteristics and component geometry).

This interface is intuitive and very easy-to-use.

7

05/10/2023

GRAPHICAL INTERFACE STRUCTURE

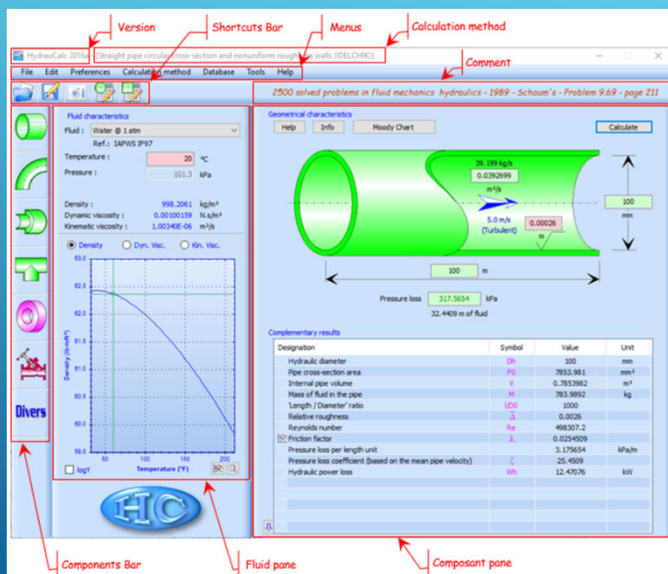

HydraulCalc - © François Corre 2017-2023

The graphical interface is structured in four main parts:

- The components bar
- The fluid pane
- The component pane
- The upper part which includes:
 - The information about release and calculation method chosen
 - Menus and shortcuts bar
 - The display area for a possible comment

8

05/10/2023

COMPONENTS BARS



The vertical components bar makes it possible to select a family of components : straight pipes, bends, changes of cross-section, tees, pipeline entrances, pipeline discharges, restriction and measurement orifices, valves, ...

Selecting a family displays, in horizontal bars, the available components for that family.

FLUID PANE

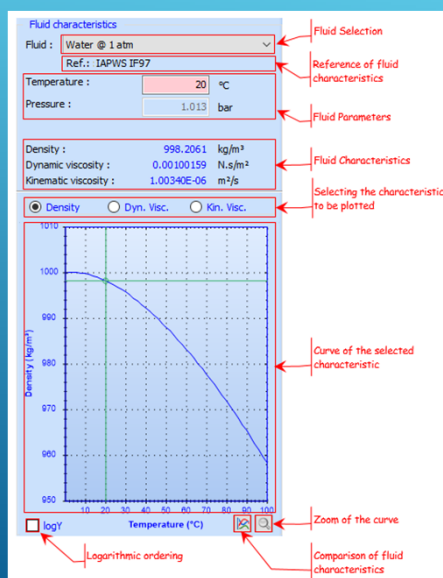

The fluid pane mainly allows:

- ❑ Select the fluid
- ❑ Set the fluid according to the selected fluid type (temperature, pressure, salinity, quality, humidity, ...)
- ❑ Visualize the characteristics of the fluid (density, dynamic and kinematic viscosity)
- ❑ Visualize the evolution of the characteristics according to the temperature or the pressure (according to the type of selected fluid)

COMPONENT PANE

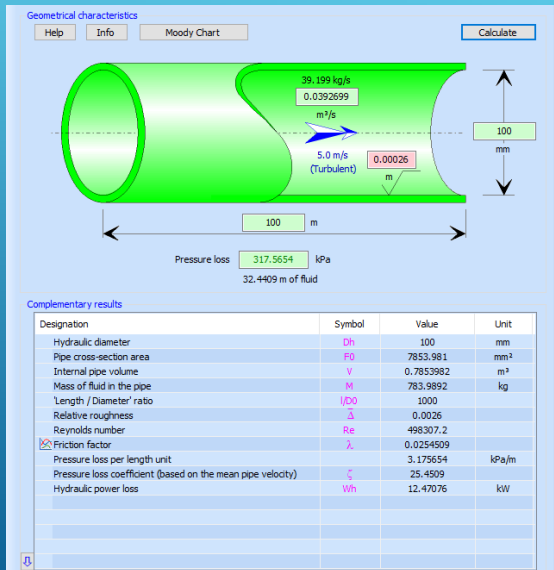

HydraulCalc - © François Corre 2017-2023

The component pane allows you to:

- Define the geometry of the component according to the selected component type (inside diameter, length, roughness, ...)
- Define flow (volume flowrate)
- Execute the calculation of the component
- Visualize the results
- Display the Moody diagram corresponding to the calculation with the calculated point (case of friction loss)
- Access information about the component:
 - Help (technical documentation of the component)
 - Info (information on the use of the component)
 - Other eventually

11

05/10/2023

COMPLEMENTARY RESULTS

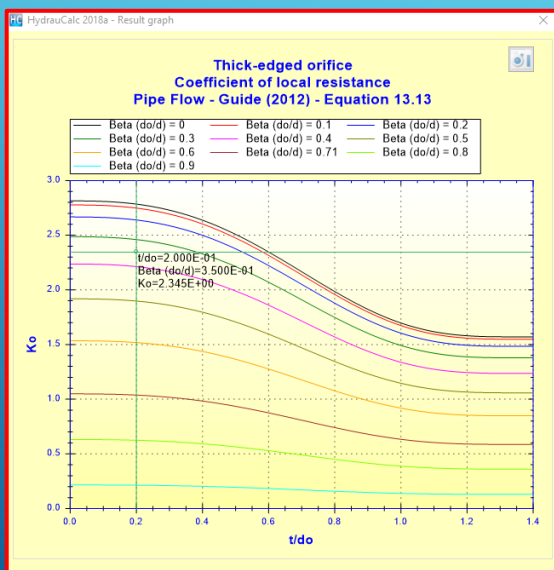

HydraulCalc - © François Corre 2017-2023

When, in the complementary results, the variable is preceded by the symbol , a simple click on this variable shows the evolution graph of the variable with the calculated point.

Example :

Designation	Symbol	Value	Unit
Pipe cross-section area	A	7853.981	mm²
Orifice cross-section area	A_o	962.1127	mm²
Diameters ratio (Do/d)	β	0.35	
Cross-sections area ratio	A_o/A	0.1225	
Thickness to orifice diameter ratio	t/Do	0.2	
Pipe Reynolds number	NR_e	498307.2	
Orifice Reynolds number	NR_{e0}	1423735	
Velocity in vena contracta	V_c	65.43075	m/s
Jet velocity ratio (Equation 13.4)	λ	1.603054	
Coefficient Cth (Equation 13.14)	C_{th}	0.9763061	
Coefficient of local resistance (Equation 13.13)	K_o	2.34488	
Pressure loss coefficient (based on the mean pipe velocity)	K	156.2602	
Hydraulic power loss	Wh	76.56641	kW

12

05/10/2023

MOODY DIAGRAM

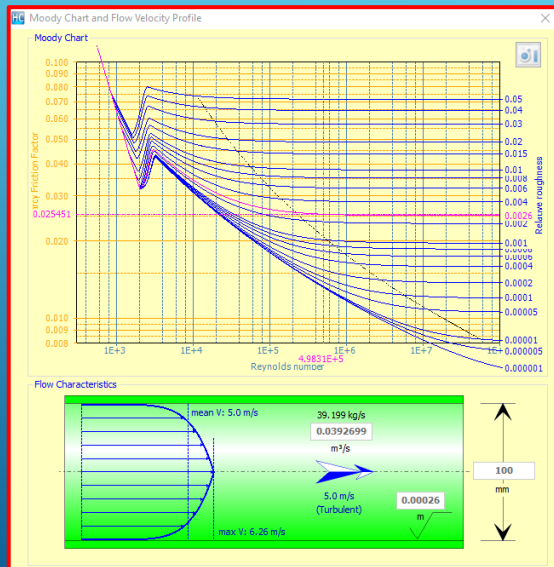

HydrauCalc - © François Corre 2017-2023

When the component is subjected to friction, the Moody diagram can be consulted to observe the operating point (as well as the flow velocity profile).

Example of a straight pipe:

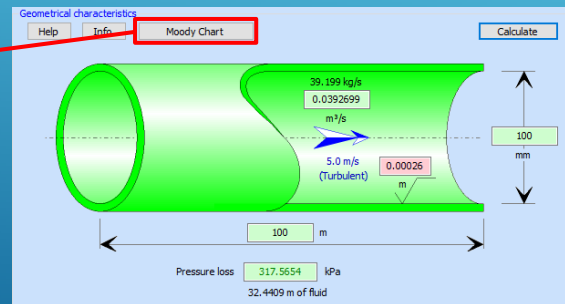

13

05/10/2023

MOODY DIAGRAM AND HAZEN-WILLIAMS FORMULA

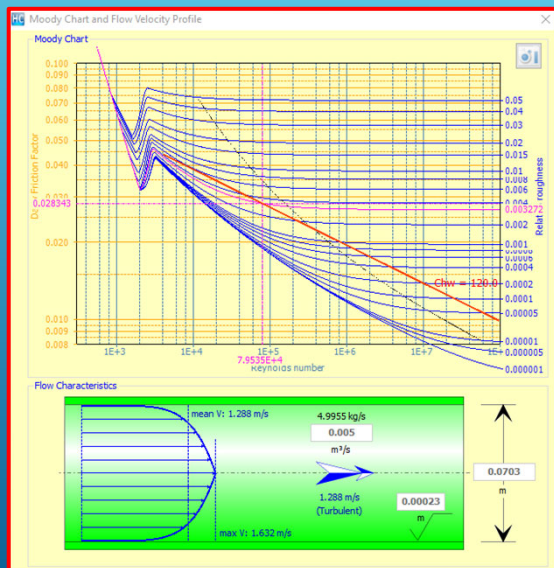

HydrauCalc - © François Corre 2017-2023

For the "Hazen-Williams" calculation method for circular cross-section straight pipes, the Moody diagram shows the relationship between the roughness coefficient of the Hazen-Williams formula and the friction coefficient of Darcy. The diagram also shows the limits of applicability of the Hazen-Williams formula.

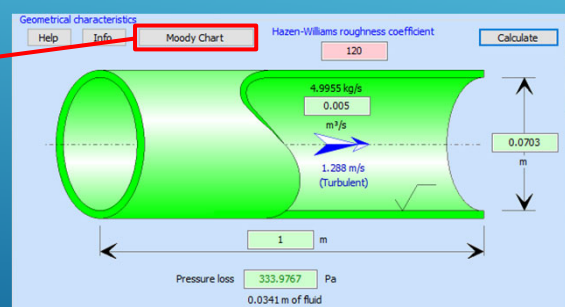

14

05/10/2023

GRID PLOT

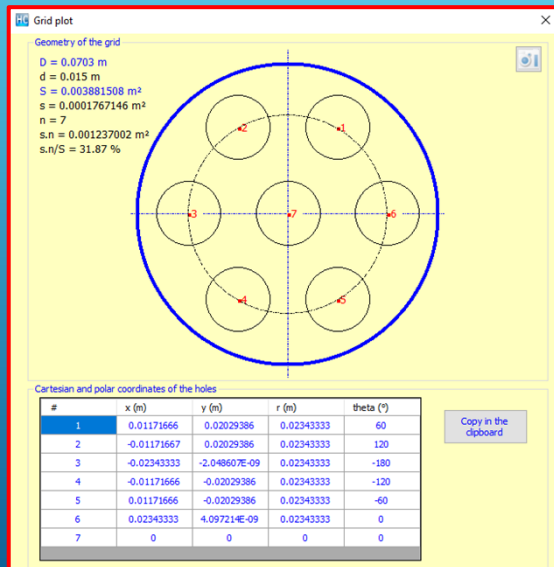

For "Grid" components (perforated plate), the application provides a grid plot with the coordinates of each hole.

Example of a perforated plate plot:

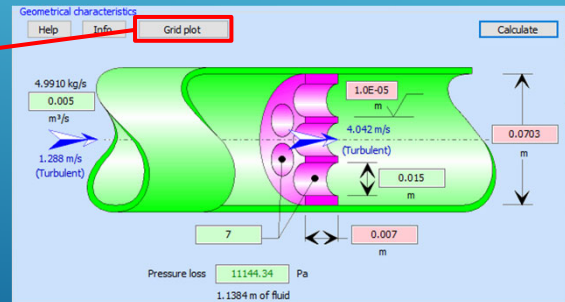

FLOW COEFFICIENT CHART

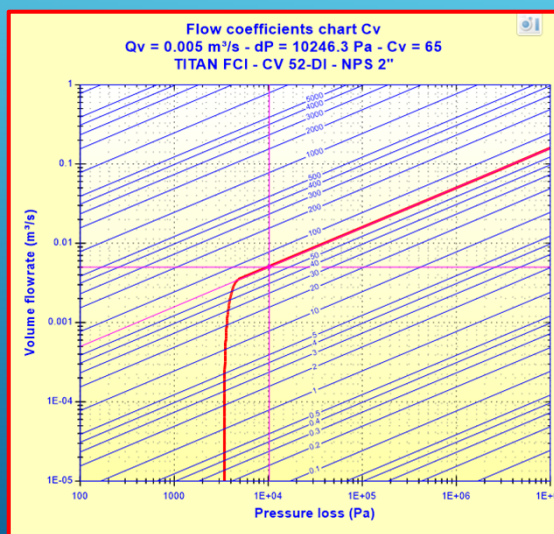

For "Valve and Check valve" components, the application provides a diagram with plot of the working point.

Example of check valve:

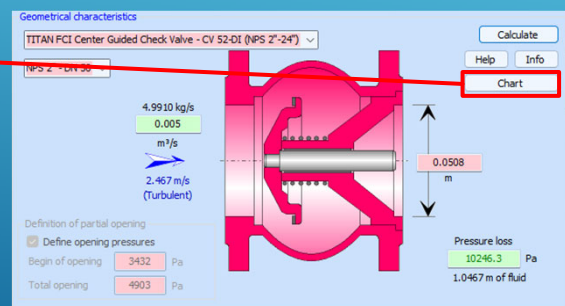

THE COMPONENTS

HydrauCalc - © François Corre 2017-2023

17
05/10/2023

STRAIGHT PIPES

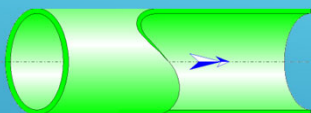

Circular cross-section

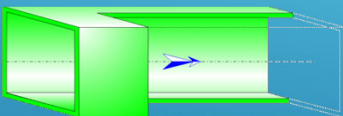

Rectangular cross-section

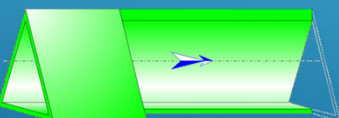

Triangular cross-section

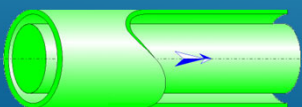

Annular cross-section

HydrauCalc - © François Corre 2017-2023

The proposed calculation methods:

- ❑ IDELCHIK
 - ❑ Uniform roughness walls (Nikuradze equation)
 - ❑ Nonuniform roughness walls (Colebrook-White equation)
 - ❑ Smooth roughness walls (Filonenko and Althul equation)
 - ❑ Explicit Darcy friction factor
- ❑ MILLER
 - ❑ Roughness walls (Swamee-Jain equation)
 - ❑ Explicit Darcy friction factor
- ❑ HAZEN-WILLIAMS (only circular cross-section)
 - ❑ Roughness walls (Hazen-Williams equation)

The proposed calculations:

- ❑ Pressure loss
- ❑ Volume flowrate
- ❑ Length of pipe
- ❑ Inside diameter (circular cross-section)
- ❑ Height or width (rectangular cross-section)
- ❑ Height or base (triangular cross-section)

18
05/10/2023

BENDS

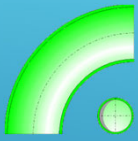

Smooth bend with circular cross-section

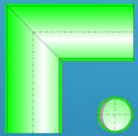

Miter bend with circular cross-section

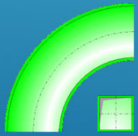

Smooth bend with rectangular cross-section

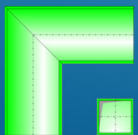

Miter bend with rectangular cross-section

HydrauCalc - © François Corre 2017-2023

The proposed calculation methods:

- ☐ IDELCHIK
- ☐ MILLER
- ☐ CRANE
- ☐ Pipe Flow Guide

The proposed calculations:

- ☐ Pressure loss
- ☐ Volume flowrate

19

10/5/2023

BENDS

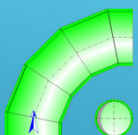

Composite bend 90° with circular cross-section (4 x 22.5°)

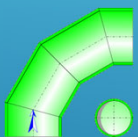

Composite bend 90° with circular cross-section (3 x 30°)

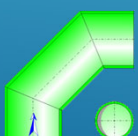

Composite bend 90° with circular cross-section (2 x 45°)

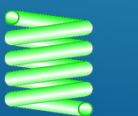

Helical tube

HydrauCalc - © François Corre 2017-2023

The proposed calculation methods:

- ☐ IDELCHIK
- ☐ MILLER
- ☐ CRANE
- ☐ Pipe Flow Guide

The proposed calculations:

- ☐ Pressure loss
- ☐ Volume flowrate

20

10/5/2023

BENDS

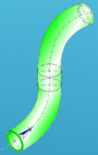

S-shaped bends with circular cross-section (flow in one plane)



S-shaped bends with circular cross-section (flow in two perpendicular planes)

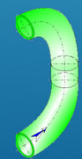

U-shaped bends with circular cross-section (flow in one plane)

HydrauCalc - © François Corre 2017-2023

The proposed calculation methods:

- ☐ IDELCHIK
- ☐ MILLER

The proposed calculations:

- ☐ Pressure loss
- ☐ Volume flowrate

21

05/10/2023

BENDS



S-shaped bends with rectangular cross-section (flow in one plane)



S-shaped bends with rectangular cross-section (flow in two perpendicular planes)



U-shaped bends with rectangular cross-section (flow in one plane)

HydrauCalc - © François Corre 2017-2023

The proposed calculation methods:

- ☐ IDELCHIK
- ☐ MILLER

The proposed calculations:

- ☐ Pressure loss
- ☐ Volume flowrate

22

05/10/2023

CHANGES OF CROSS-SECTION

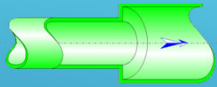

Sudden expansion

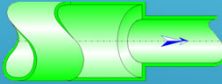

Sudden contraction sharp

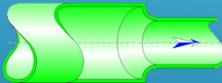

Sudden contraction rounded

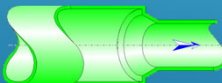

Sudden contraction bevelled

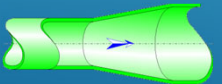

Gradual expansion

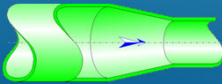

Gradual contraction

HydrauCalc - © François Corre 2017-2023

The proposed calculation methods:

- ☐ IDELCHIK
- ☐ MILLER
- ☐ CRANE
- ☐ Pipe Flow Guide

The proposed calculations:

- ☐ Pressure loss
- ☐ Volume flowrate

23

05/10/2023

ENTRANCE OF PIPELINE



Flush-mounted sharp-edged entrance

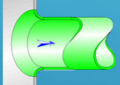

Flush-mounted rounded entrance

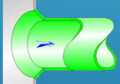

Flush-mounted bevelled entrance



Sharp-edged entrance mounted at a distance

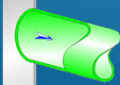

Sharp-edged entrance mounted at an angle

HydrauCalc - © François Corre 2017-2023

The proposed calculation methods:

- ☐ IDELCHIK
- ☐ MILLER
- ☐ CRANE
- ☐ Pipe Flow Guide

The proposed calculations:

- ☐ Pressure loss
- ☐ Volume flowrate

24

05/10/2023

ENTRANCE OF PIPELINE

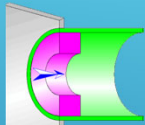

Entrance through a thick-edged orifice

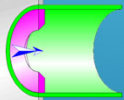

Entrance through a sharp-edged orifice

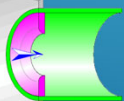

Entrance through a round-edged orifice

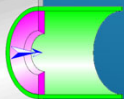

Entrance through a bevel-edged orifice

HydrauCalc - © François Corre 2017-2023

New R2023b

The proposed calculation method:

- IDELCHIK

The proposed calculations:

- Pressure loss
- Volume flowrate
- Orifice diameter

25

05/10/2023

ENTRANCE OF PIPELINE

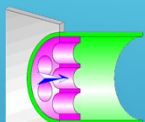

Entrance through a thick-edged grid

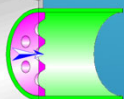

Entrance through a sharp-edged grid

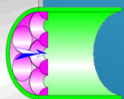

Entrance through a round-edged grid

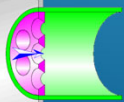

Entrance through a bevel-edged grid

HydrauCalc - © François Corre 2017-2023

New R2023b

The proposed calculation method:

- IDELCHIK

The proposed calculations:

- Pressure loss
- Volume flowrate
- Holes diameter
- Holes number

26

05/10/2023

DISCHARGE OF PIPELINE



Flush-mounted sharp-edged discharge

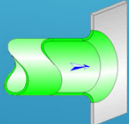

Flush-mounted rounded discharge

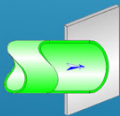

Sharp-edged discharge mounted at a distance

HydrauCalc - © François Corre 2017-2023

The proposed calculation methods:

- ☐ IDELCHIK
- ☐ MILLER
- ☐ CRANE
- ☐ Pipe Flow Guide

The proposed calculations:

- ☐ Pressure loss
- ☐ Volume flowrate

27

05/10/2023

DISCHARGE OF PIPELINE

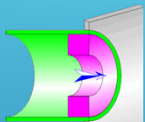

Discharge from a thick-edged orifice

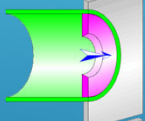

Discharge from a sharp-edged orifice

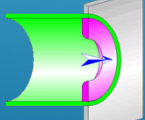

Discharge from a round-edged orifice

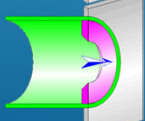

Discharge from a bevel-edged orifice

HydrauCalc - © François Corre 2017-2023

New R2023b

The proposed calculation method:

- ☐ IDELCHIK

The proposed calculations:

- ☐ Pressure loss
- ☐ Volume flowrate
- ☐ Orifice diameter

28

05/10/2023

DISCHARGE OF PIPELINE

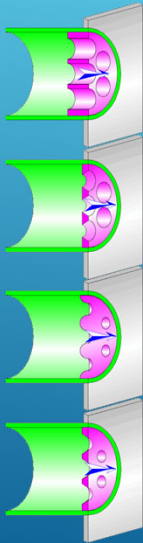

Discharge from a thick-edged grid

Discharge from a sharp-edged grid

Discharge from a round-edged grid

Discharge from a bevel-edged grid

HydrauCalc - © François Corre 2017-2023

New R2023b

The proposed calculation method:

- IDELCHIK

The proposed calculations:

- Pressure loss
- Volume flowrate
- Holes diameter
- Holes number

29

05/10/2023

JUNCTIONS

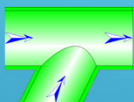

Combining sharp-edged junction

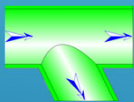

Dividing sharp-edged junction

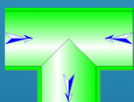

Symmetric combining sharp-edged T-junction

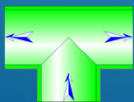

Symmetric dividing sharp-edged T-junction

HydrauCalc - © François Corre 2017-2023

The proposed calculation methods:

- IDELCHIK
- MILLER
- CRANE

The proposed calculation:

- Pressure loss in each branch

30

05/10/2023

JUNCTIONS (FOLLOWING)

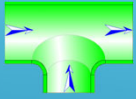

Combining radiused-edged T-junction

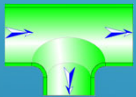

Dividing radiused-edged T-junction

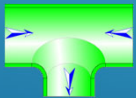

Symmetric combining radiused-edged T-junction

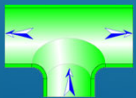

Symmetric dividing radiused-edged T-junction

HydrauCalc - © François Corre 2017-2023

The proposed calculation methods:

- MILLER
- Pipe Flow Guide

The proposed calculation:

- Pressure loss in each branch

31

05/10/2023

T-JUNCTIONS WITH SMOOTH TURN THROUGH 90°

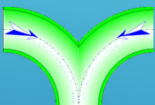

Symmetric combining T-junction with smooth turn through 90°

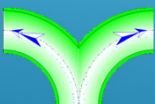

Symmetric dividing T-junction with smooth turn through 90°

HydrauCalc - © François Corre 2017-2023

The proposed calculation method:

- IDELCHIK

The proposed calculation:

- Pressure loss in each branch

32

05/10/2023

Y-JUNCTIONS

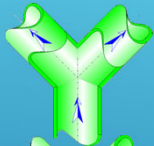

Symmetrical dividing Y-junction
with branches of equal sections

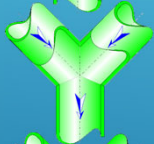

Symmetrical combining Y-junction
with branches of equal sections

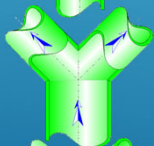

Symmetrical dividing Y-junction
with branches of unequal sections

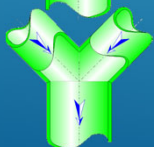

Symmetrical combining Y-junction
with branches of unequal sections

HydrauCalc - © François Corre 2017-2023

The proposed calculation methods:

- IDELCHIK
- MILLER

The proposed calculation:

- Pressure loss in each branch

33

05/10/2023

FOUR-WAY JUNCTIONS

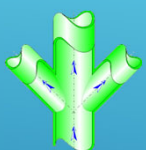

Four-way dividing junction
with branches of unequal sections

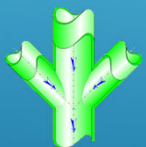

Four-way combining junction
with branches of unequal sections

HydrauCalc - © François Corre 2017-2023

The proposed calculation method:

- IDELCHIK

The proposed calculation:

- Pressure loss in each branch

34

05/10/2023

RESTRICTION ORIFICES

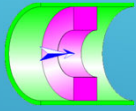

Thick-edged orifice

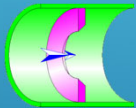

Sharp-edged orifice

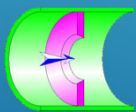

Bevel-edged orifice

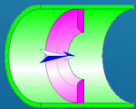

Round-edged orifice

HydrauCalc - © François Corre 2017-2023

The proposed calculation methods:

- ☐ IDELCHIK
- ☐ MILLER
- ☐ CRANE
- ☐ Pipe Flow Guide

The proposed calculations:

- ☐ Pressure loss
- ☐ Volume flowrate
- ☐ Orifice diameter

35

05/10/2023

RESTRICTION ORIFICES (FOLLOWING)

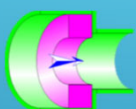

Thick-edged orifice
(in transition section)

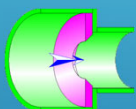

Sharp-edged orifice
(in transition section)

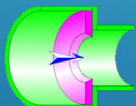

Bevel-edged orifice
(in transition section)

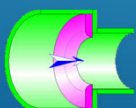

Round-edged orifice
(in transition section)

HydrauCalc - © François Corre 2017-2023

The proposed calculation methods:

- ☐ IDELCHIK
- ☐ Pipe Flow Guide

The proposed calculations:

- ☐ Pressure loss
- ☐ Volume flowrate
- ☐ Orifice diameter

36

05/10/2023

GRIDS

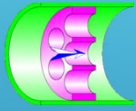

Thick-edged grid

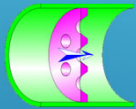

Sharp-edged grid

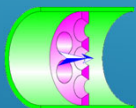

Bevel-edged grid

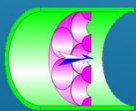

Round-edged grid

HydrauCalc - © François Corre 2017-2023

The proposed calculation methods:

- ☐ IDELCHIK
- ☐ MILLER
- ☐ Pipe Flow Guide

The proposed calculations:

- ☐ Pressure loss
- ☐ Volume flowrate
- ☐ Holes diameter
- ☐ Holes number

37

05/10/2023

MEASUREMENT ORIFICES

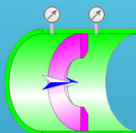

Orifice plate flowmeter

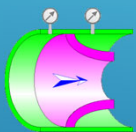

Nozzle and Venturi nozzle flowmeter

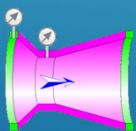

Venturi tube flowmeter

HydrauCalc - © François Corre 2017-2023

The proposed calculation methods:

- ☐ ISO 5167:2003
- ☐ ISO 5167:1991
- ☐ CRANE 1999

The proposed calculations:

- ☐ Measured differential pressure
- ☐ Net pressure loss
- ☐ Volume flowrate
- ☐ Orifice diameter

38

05/10/2023

VALVES



Y globe valve

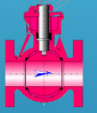

Ball valve

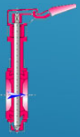

Butterfly valve

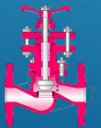

Globe valve

HydrauCalc - © François Corre 2017-2023

The proposed calculation methods:

- ☐ IDELCHIK
- ☐ MILLER
- ☐ Manufacturers

The proposed calculations:

- ☐ Pressure loss
- ☐ Volume flowrate

39

05/10/2023

CHECK VALVES

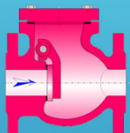

Swing check valve

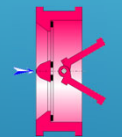

Dual plate check valve

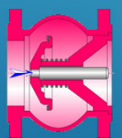

Axial check valve

HydrauCalc - © François Corre 2017-2023

The proposed calculation method:

- ☐ Manufacturers

The proposed calculations:

- ☐ Pressure loss
- ☐ Volume flowrate

40

05/10/2023

PUMP QUICK DESIGN

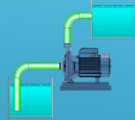

Suction lift operation
Tank with pipe ending below the fluid level

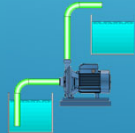

Suction lift operation
Free flow from the pipe ending above the water level

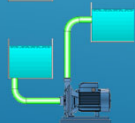

Suction head operation
Tank with pipe ending below the fluid level

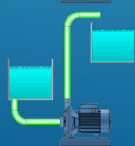

Suction head operation
Free flow from the pipe ending above the water level

HydrauCalc - © François Corre 2017-2023

The proposed calculation method:

- KSB Manufacturer

The proposed calculations:

- Total Dynamic Head (TDH)
- Net Positive Suction Head available (NPSH_a)
- Pressure loss in suction and discharge lines
- Pressures at the pump flanges

41

05/10/2023

THE MEASURE UNITS

HydrauCalc - © François Corre 2017-2023

42

05/10/2023

UNIT SYSTEM SELECTION

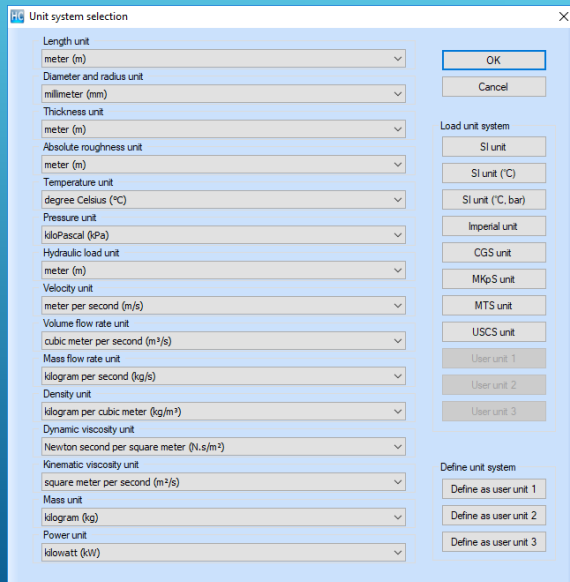

Units can be selected:

- individually
- by unit systems

The user can define his own systems of units (within the limit of three systems)

43

05/10/2023

UNITS MODIFICATION

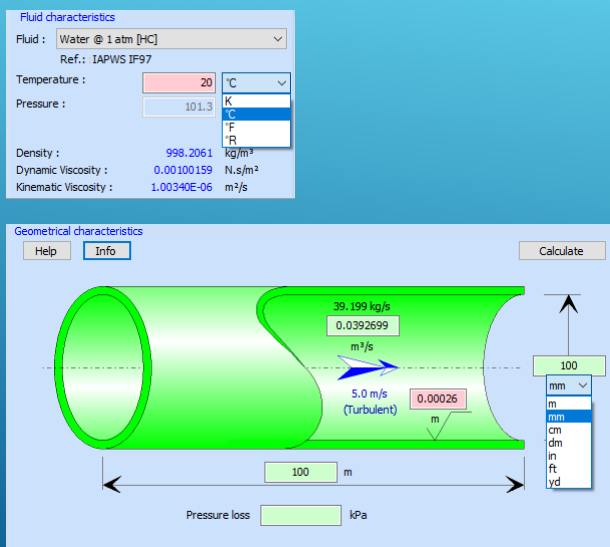

The application has a dynamic unit conversion engine.

The units displayed in the Fluid Pane and Component Data Panes can be changed by simply clicking on the unit displayed.

After selecting a new unit, the value entered in the input box is automatically converted to the new unit.

The results will be displayed in the current units.

44

05/10/2023

THE DATABASES

DATABASE - FLUIDS

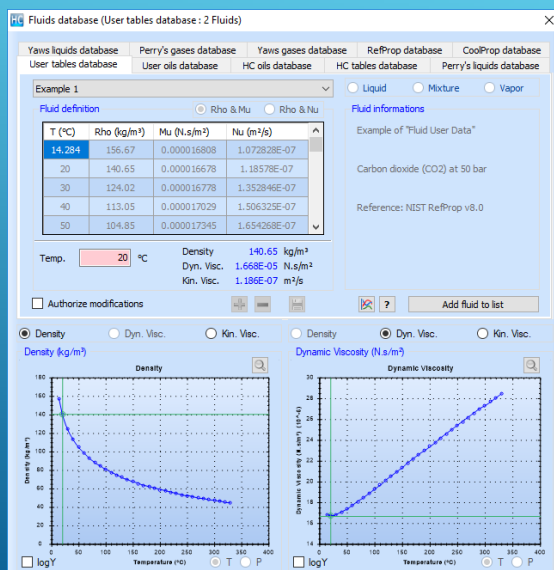

HydrauCalc has a fluid characteristics database consisting of several hundred fluids based on recognized references:

- Perry's Handbook
- Oil products
- Yaws Handbook
- Coolprop
- Refprop **New R2023b**

The user can also define his own fluids in the form of point tables as a function of temperature.

DATABASE - ROUGHNESS COEFFICIENT

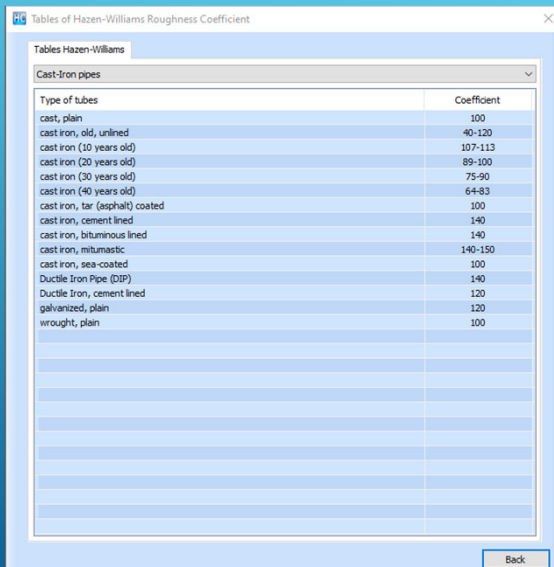

Type of tubes	Coefficient
cast, plain	100
cast iron, old, unlined	40-120
cast iron (10 years old)	107-113
cast iron (20 years old)	89-100
cast iron (30 years old)	75-90
cast iron (40 years old)	64-83
cast iron, tar (asphalt) coated	100
cast iron, cement lined	140
cast iron, bituminous lined	140
cast iron, bitumastic	140-150
cast iron, sea-coated	100
Ductile Iron Pipe (DIP)	140
Ductile Iron, cement lined	120
galvanized, plain	120
wrought, plain	100

HydrauCalc has a database of values of Hazen-Williams roughness coefficient from:

- Hydraulic Tables by GARDNER S. WILLIAMS and ALLEN HAZEN - 2nd Ed. (1914)

THE TOOLS

TOOL - CALCULATOR FOR CIRCULAR CROSS-SECTIONS

General Head Drop Formulas
for Steady State and Incompressible Fluid

Formulation

$$\Delta P = 1/2 \cdot \zeta \cdot \rho \cdot V^2$$

$$\zeta = \lambda \cdot L / d$$

$$Q_v = V \cdot S$$

$$S = \pi \cdot d^2 / 4$$

$$Q_m = \rho \cdot Q_v$$

$$Re = V \cdot d / \nu$$

$$Av = Q_v \cdot (\rho / \Delta P)^{0.5}$$

$$Cv = 41650 \cdot Av$$

$$Kv = 36023 \cdot Av$$

$$Cv = 1.15620 \cdot Kv$$

$$\zeta = 2 \cdot S^2 / Av^2$$

$$\Delta h = \Delta P / (\rho \cdot g)$$

$$Wh = \Delta P \cdot Q_v$$

$$\nu = \mu / \rho$$

Numerical application

☐ ΔP = 1699.584 lbf/ft²

☐ ζ = 20.85395

☐ λ = 0.01737829

☒ L = 200 ft

☒ V = 9.17 ft/s

☐ Q_v = 0.2000584 ft³/s

☒ d = 2 in

☐ S = 3.141593 in²

☐ Q_m = 5.659446 kg/s

☐ Re = 126532.3

☐ Av = 0.006276798 m³

☐ Cv = 26.14297 USG/min

☐ Kv = 22.61094 m³/h

☐ Δh = 27.25155 ft of fluid

☒ Wh = 461 W



 Check the input data

Reset

The application allows, from known input data and for circular cross-sections, to automatically calculate those that can be deduced.

It is thus possible to determine the volume flowrate corresponding, for example, to an imposed mean velocity, so as to inform the input data of the components.

TOOL - CALCULATOR FOR RECTANGULAR CROSS-SECTIONS

General Head Drop Formulas
for Steady State and Incompressible Fluid

Formulation

$$\Delta P = 1/2 \cdot \zeta \cdot \rho \cdot V^2$$

$$\zeta = \lambda \cdot L / dh$$

$$Q_v = V \cdot S$$

$$S = a \cdot b$$

$$P = 2 \cdot (a + b)$$

$$dh = 4 \cdot S / P$$

$$Q_m = \rho \cdot Q_v$$

$$Re = V \cdot dh / \nu$$

$$Av = Q_v \cdot (\rho / \Delta P)$$

$$Cv = 41650 \cdot Av$$

$$Kv = 36023 \cdot Av$$

$$Cv = 1.15620 \cdot Kv$$

$$\zeta = 2 \cdot S^2 / Av^2$$

$$\Delta h = \Delta P / (\rho \cdot g)$$

$$Wh = \Delta P \cdot Q_v$$

$$\nu = \mu / \rho$$

Numerical application

☐ ΔP = 23.38326 Pa

☐ ζ = 0.8365216

☐ λ = 0.02048625

☒ L = 7 m

☐ V = 6.985055 m/s

☐ Q_v = 0.2095516 m³/s

☒ a = 15 cm

☒ b = 20 cm

☐ P = 69.99998 cm

☐ S = 300 cm²

☐ dh = 17.14286 cm

☐ Q_m = 0.2401094 kg/s

☒ Re = 72490

☐ Av = 0.04638713 m³

☐ Cv = 1932.032 USG/min

☐ Kv = 1671.006 m³/h

☐ Δh = 2.080971 m of fluid

☒ Wh = 4.9 W

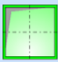

 Check the input data

Reset

The application also makes it possible, from known input data and for rectangular cross-sections, to calculate those that can be deduced from it.

It is thus possible to determine the volume flowrate corresponding, for example, to an imposed Reynolds number, so as to inform the input data of the components.

TOOL - UNITS CONVERSION

Units conversion factors

Mass flow rate	Force	Pressure	Energy	Power	Density	Kinematic Viscosity	Dynamic Viscosity
Length	Mass	Time	Temperature	Area	Volume	Velocity	Volume flow rate
Unit name	Symbol	Value					
S.I. unit : meter per second	m/s	1 m/s					
millimeter per second	mm/s	0.001 m/s					
decimeter per second	dm/min	0.1/60 m/s					
centimeter per second	cm/s	0.01 m/s					
meter per minute	m/min	1/60 m/s					
decimeter per minute	dm/s	0.1 m/s					
decimeter per minute	dm/min	10/60 m/s					
kilometer per hour	km/h	1000/3600 m/s					
hectometer per minute	hm/min	100/60 m/s					
decameter per second	dam/s	10 m/s					
kilometer per minute	km/min	1000/60 m/s					
foot per minute	ft/min	0.00508 m/s					
foot per minute	fpm	0.00508 m/s					
yard per minute	yd/min	0.01524 m/s					
yard per minute	ypm	0.01524 m/s					
inch per second	in/s	0.0254 m/s					
inch per second	ips	0.0254 m/s					
foot per second	ft/s	0.3048 m/s					
foot per second	fps	0.3048 m/s					
mile per hour	mile/h	0.44704 m/s					
mile per hour	mph	0.44704 m/s					
yard per second	yd/s	0.9144 m/s					
yard per second	yps	0.9144 m/s					
mile per minute	mile/min	26.8224 m/s					
mile per minute	mpm	26.8224 m/s					

Conversion

from

to

Back

HydrauCalc - © François Corre 2017-2023

The application has a tool allowing:

- to view the conversion factors of the measurement units integrated in the application,
- to convert together units of measurement of the same physical size.

53

05/10/2023

TOOL - ESTIMATE PRESSURE LOSS COEFFICIENT IN LAMINAR FLOW

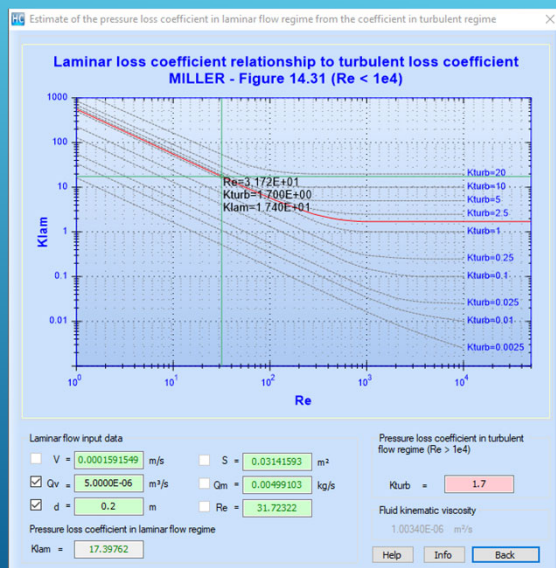

HydrauCalc - © François Corre 2017-2023

The application has a tool making it possible to obtain an estimate of the coefficient of pressure loss in the laminar flow regime, if the coefficient of pressure loss in the turbulent flow regime is known.

This method only applies to minor pressure losses (pipe fittings, valves, etc.) and is based on the following reference book:

- Internal Flow System, D.S. Miller

54

05/10/2023

TOOL - MOODY DIAGRAM

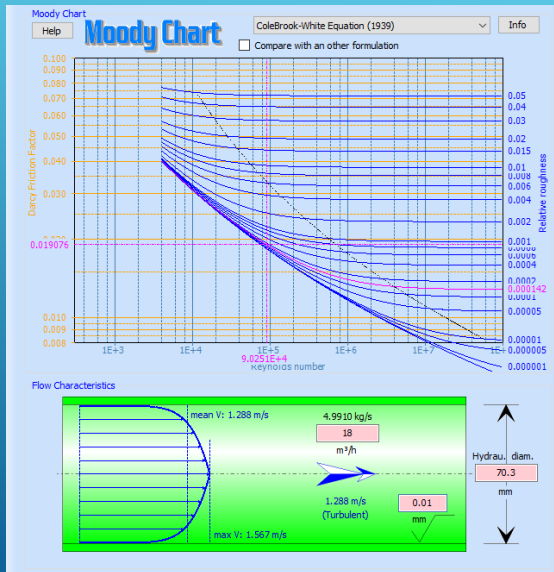

HydrauCalc - © François Corre 2017-2023

The application has a tool to calculate the coefficient of friction from more than 40 other formulations published by recognized scientists. The curves of iso-values of relative roughness are plotted in a Moody diagram and the calculated point is presented.

The velocity profile of the flow corresponding to the calculation point is also plotted in a pipe of same hydraulic diameter as that of the component.

55

05/10/2023

TOOL - MOODY DIAGRAM (FOLLOWING)

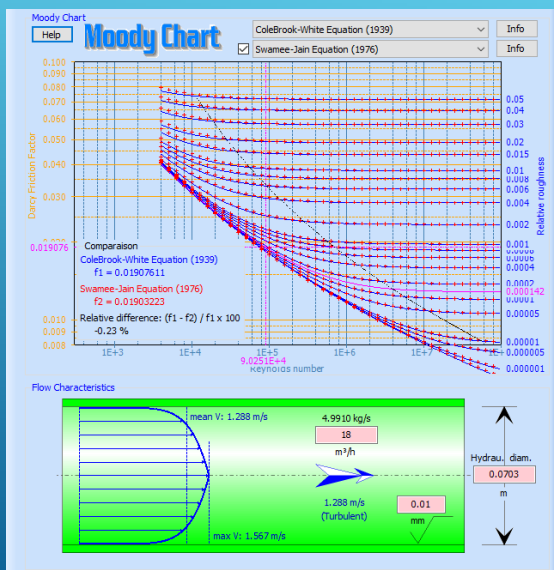

HydrauCalc - © François Corre 2017-2023

This tool also makes it possible to compare two different formulations for determining the Darcy friction coefficient.

The relative difference found at the calculation point is calculated and displayed on the diagram.

56

05/10/2023

TOOL - VALVE SIZING CHART

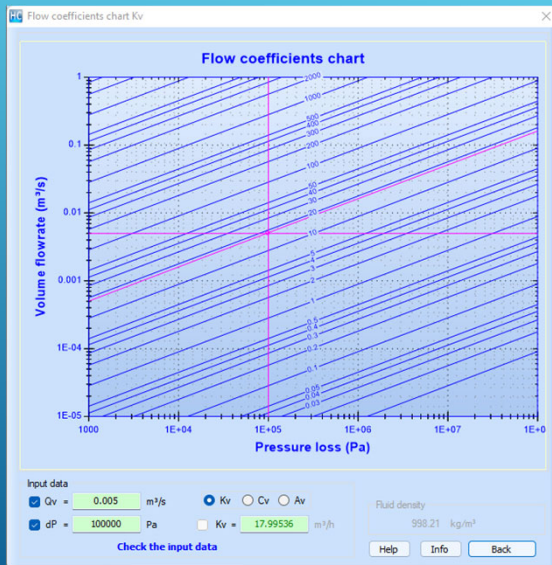

HydrauCalc - © François Corre 2017-2023

The application has a valve sizing aid chart.

The user selects the type of flow coefficient: Kv, Cv or Av.

It then selects two of the three input data (volume flow, pressure loss or value of the flow coefficient) in order to calculate the third.

57

05/10/2023

TOOL - FLUID COMPARATOR

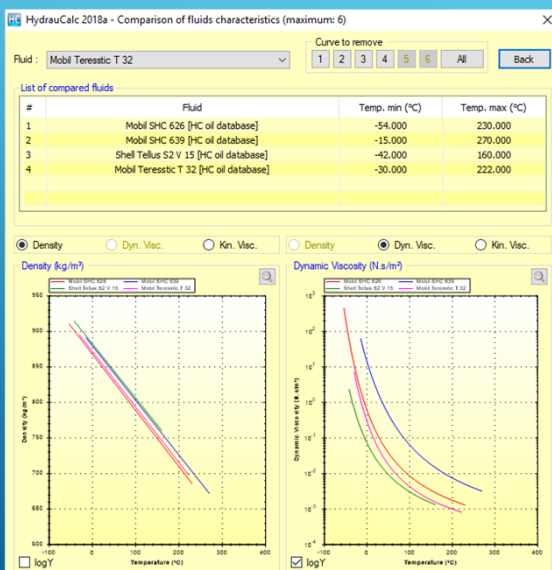

HydrauCalc - © François Corre 2017-2023

The application has a tool to compare the characteristics of the fluids integrated in the application or defined by the user (density, dynamic viscosity and kinematic viscosity).

58

05/10/2023

THE CALCULATION REPORT

CALCULATION REPORT

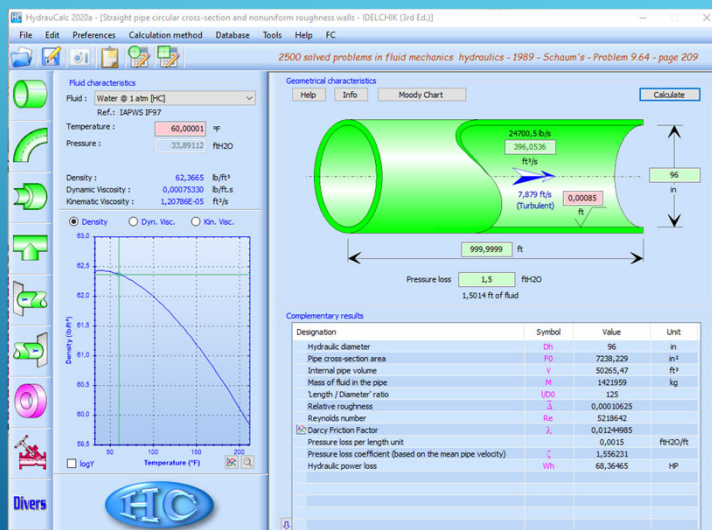

To include a calculation result in a document, it is possible to copy the window using the button  and paste it into the document.

The screenshot contains all the data used for the calculation and the results:

- in the title bar:
 - the release of the application,
 - the type of component calculated and the calculation method used,
- in the fluid pane:
 - the characteristics of the fluid used,
- in the component pane:
 - the input data of the component,
 - the desired main result (value in green colour),
 - the additional results from the calculation.

THE DATA EXPORT

DATA EXPORT

	A	B	C	D	E	F	G
1							
2							
3							
4		Straight pipe circular cross-section and nonuniform roughness walls - IDELCHIK (3rd Ed.)					
5		Diameter	0,3333598 m				
6		Pipe cross-section area	0,08728033 m²				
7		Length	609,6 m				
8		Absolute Roughness	4,60E-005 m				
9		Volume flow rate	25,57719 m³/s				
10		Pressure loss	1,00E+009 Pa				
11		Fluid head	102191,5 m of fluid				
12		Pressure loss coefficient	23,33955				
13		Darcy Friction Factor	0,01276324				
14		Flow velocity	293,0464 m/s				
15		Reynolds number	1,00E+008				
16		Hydraulic power loss	2,56E+010 W				
17		Density	997,9705 kg/m³				
18		Dynamic Viscosity	9,75E-004 N.s/m²				
19		Kinematic Viscosity	9,77E-007 m²/s				
20							
21							

For each component, the input data and the main results can be copied to the clipboard, using the button , for reuse in another application, for example a spreadsheet.

DATA EXPORT

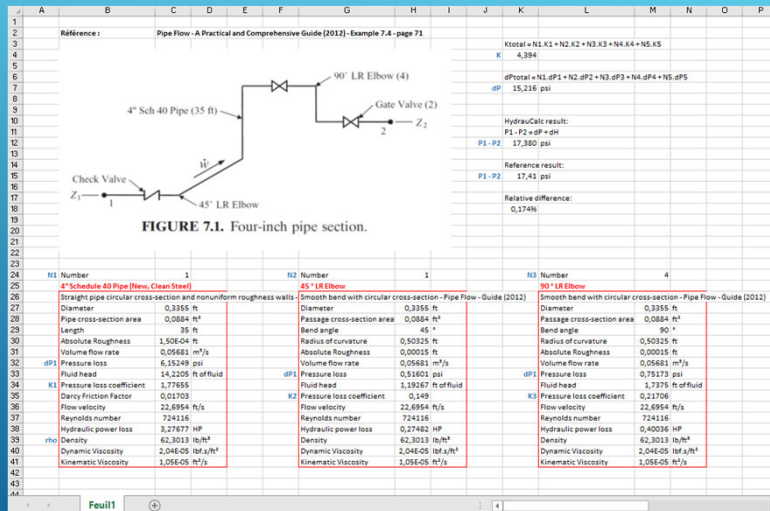

Exporting the main data and results to a spreadsheet allows you to perform additional calculations such as:

- Calculation of the total pressure loss of the circuit by summing the pressure losses of each component.
- Search for the flow circulating in the circuit from the sum of the pressure loss coefficients and using the solver integrated into the spreadsheet.

HydraulCalc - © François Corre 2017-2023

63
05/10/2023

Data exchange with HydraulCalcXL

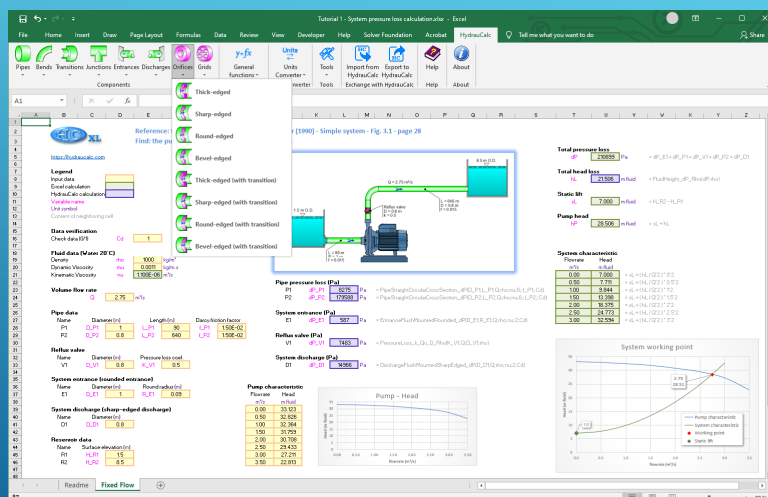

HydraulCalcXL Add-in is a library of functions that has been developed to calculate the pressure losses of hydraulic components in Microsoft Excel®. This library allows the direct call of functions relating to the calculation of pressure losses. It comes from the HydraulCalc application.

The HydraulCalcXL functions can be used via the user interface of Excel, like the own integrated functions of Excel.

HydraulCalc - © François Corre 2017-2023

64
05/10/2023

Data export to HydraulCalcXL

1 - Export function to Clipboard

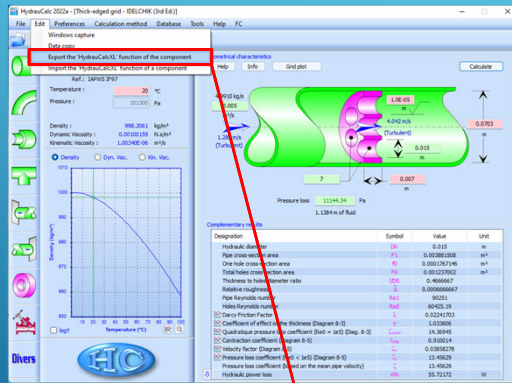

2 - Import function from Clipboard

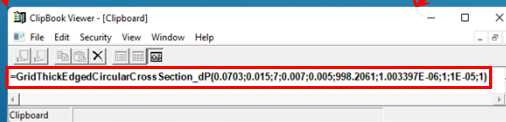
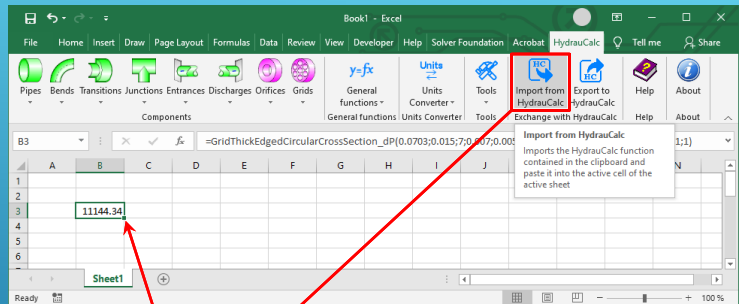

HydraulCalc - © François Corre 2017-2023

65
05/10/2023

Data import from HydraulCalcXL

1 - Export function to Clipboard

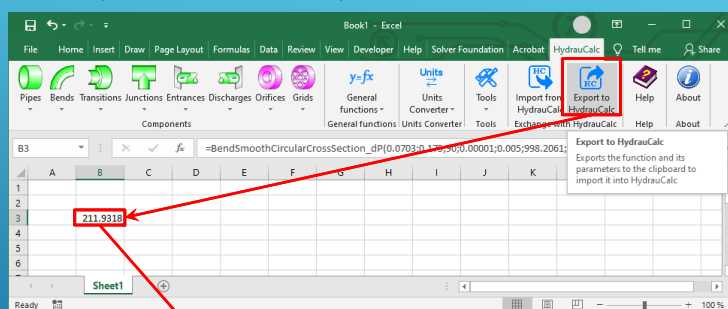

2 - Import function from Clipboard

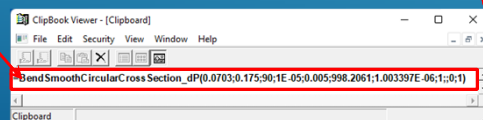
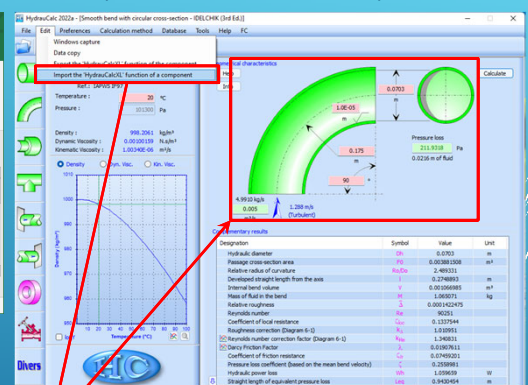

HydraulCalc - © François Corre 2017-2023

66
05/10/2023

THE ASSURANCE QUALITY

TECHNICAL DOCUMENTATION

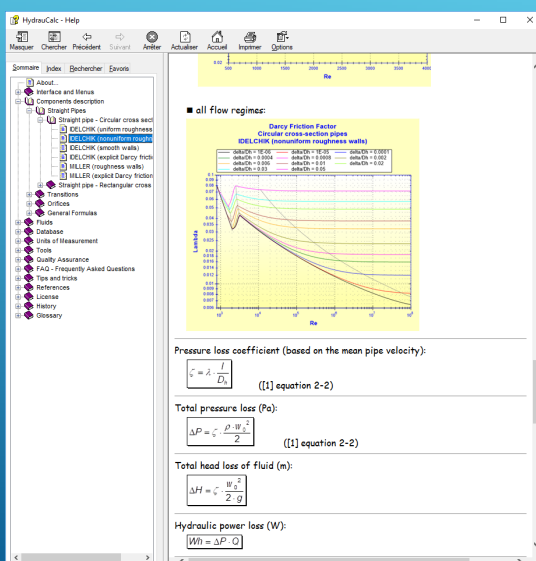

In general, each component has several calculation methods that come from different reference works. For all components, each calculation method is detailed in a technical document including:

- A description of the method used
- The mathematical formulation of the model
- The nomenclature used for the equations
- The range of the formulation
- An example of an application
- The bibliographic reference (s) used for modelling

COMPONENTS MODEL VALIDATION

HydrauCalc comes with a document that provides a comparison of software results with a series of examples published in well-known and respected references. Examples of hydraulic analysis include calculations of flow, pressure drop and pipe sizing for compressible and incompressible fluids.

The results obtained by the HydrauCalc application are very close to the published results.

At each new software release, a series of tests is performed to check the non-regression of the software features.

HydrauCalc

2023b Release

www.hydraucalc.com